



ROLLBLOC-Keilspanner KS

Projektierungs-Maße

H	I	K	M	ØN	O	P	R	S	T	U	V	W
48	122	58	70	30	20	3	21,5	78	33	15	12	11
65	157	78	95	40	25	3	28,5	103	43	18	6	11
80	190	100	120	56	25	3	37	127	51	25	16	11
105	222	120	150	70	30	3	49	148	57	30	8	11

KS02...

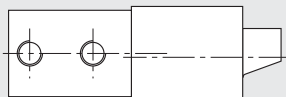

KS05...

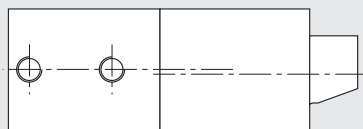

KS10...

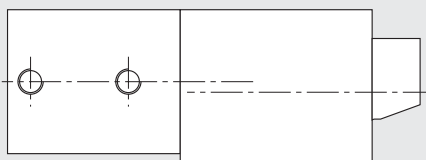

KS16...

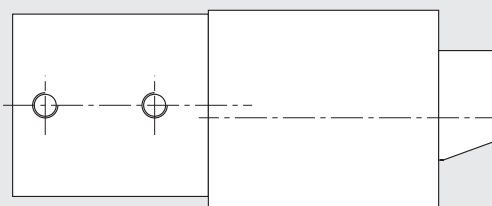

Werkzeuganschluss-Maße

